

# Produktdatablad

Specifikationer



## Harmony paddetrykshoved i plast med Ø40 mm padde i grøn farve med fjeder-retur

El-nr.:

7517903693

ZB5AC3

EAN-nr: 3389110904888

## Egenskaber

|                                 |                                       |
|---------------------------------|---------------------------------------|
| Produktserie                    | Harmony XB5                           |
| Produkttype                     | Hoved til trykknop                    |
| Enhedsforkortelse               | ZB5                                   |
| Materiale og farve på frontring | Mørkegrå plast                        |
| Hovedtype                       | Standard                              |
| Montagediameter                 | 22 mm                                 |
| Mindst mulige salgsantal        | 1                                     |
| Form på hoved                   | Rundt                                 |
| Betjeningsprofil                | fjeder-retur                          |
| Betjeningsprofil                | Grøn Paddetryk Ø 40 mm, Uden mærkning |
| Konstruktion                    | Som løsdele                           |

## Produktinformationer

|                                  |   |
|----------------------------------|---|
| Bredde                           | 40 mm   |
| Højde                            | 40 mm   |
| Dybde                            | 52 mm   |
| Vægt                             | 0,046 kg  |
| Mekanisk holdbarhed              | 5000000 kredsløb  |
| Kanalnavn                        | XALD 1 montagehul<br>XALK 1 montagehul  |
| Kode for elektrisk sammensætning | C1 til <9 kontakter benytter enkelt blokke i Montering forfra<br>C2 til <9 kontakter benytter enkelt og dobbelt blokke i Montering forfra<br>C11 til <3 kontakter benytter enkelt blokke i Montering forfra<br>C15 til <1 kontakter benytter enkelt blokke i Montering forfra<br>SF1 til <3 kontakter benytter enkelt blokke i Montering forfra<br>SR1 til <3 kontakter benytter enkelt blokke i Montering bagfra |
| Kompatibilitetskode              | ZB5   |

## Miljø

|                                     |                                   |
|-------------------------------------|-----------------------------------|
| Beskyttelsesbehandling              | TH                                |
| Omgivelsestemperatur ved opbevaring | -40...70 °C                       |
| Omgivelsestemperatur under drift    | -40...70 °C                       |
| Overspændingskategori               | Klasse II conforming to IEC 60536 |

|  |  |
|--|--|
| <b>IP kapslingsklasse</b>                          | IP66 i henhold til IEC 60529<br>IP69<br>IP69K  |
| <b>NEMA kapslingsklasse</b>                        | NEMA 13<br>NEMA 4X   |
| <b>Modstandsdygtighed overfor højtryksrensning</b> | 7000000 Pa ved 55 °C, distance : 0.1 m   |
| <b>IP kapslingsklasse</b>                          | IK03 conforming to IEC 50102   |
| <b>Standarder</b>                                  | JIS C8201-5-1<br>CSA C22.2 No 14<br>IEC 60947-5-1<br>IEC 60947-1<br>UL 508<br>IEC 60947-5-4<br>JIS C8201-1   |
| <b>Produktcertificeringer</b>                      | CSA<br>DNV<br>BV<br>LROS (Lloyds register of shipping)<br>UL listet  |
| <b>Vibrationsmodstand</b>                          | 5 gn (f= 2...500 Hz) conforming to IEC 60068-2-6   |
| <b>Modstandsdygtighed overfor stød</b>             | 30 gn (varighed = 18 milisekund) til Halv sinusbølge acceleration i henhold til IEC 60068-2-27<br>50 gn (varighed = 11 milisekund) til Halv sinusbølge acceleration i henhold til IEC 60068-2-27 |

## Forpakkingsinformation

|                                |           |
|--------------------------------|-----------|
| <b>Enhedstype af pakke 1</b>   | PCE       |
| <b>Antal enheder i pakke 1</b> | 1         |
| <b>Pakke 1 Højde</b>           | 8,800 cm  |
| <b>Pakke 1 Længde</b>          | 4,400 cm  |
| <b>Package 1 Length</b>        | 5,400 cm  |
| <b>Pakke 1 Vægt</b>            | 46,000 g  |
| <b>Enhedstype af pakke 2</b>   | S02       |
| <b>Antal enheder i pakke 2</b> | 42        |
| <b>Pakke 2 Højde</b>           | 15,000 cm |
| <b>Pakke 2 Bredde</b>          | 30,000 cm |
| <b>Pakke 2 Længde</b>          | 40,000 cm |
| <b>Pakke 2 Vægt</b>            | 2,315 kg  |

## Logistik informationer

|                        |    |
|------------------------|----|
| <b>Oprindelsesland</b> | CZ |
|------------------------|----|

## Garanti

|                |           |
|----------------|-----------|
| <b>Garanti</b> | 18 months |
|----------------|-----------|

## Environmental Data

Schneider Electric's mål er at opnå Net Zero-status i 2050 gennem partnerskaber med forsyningskæden, materialer med lavere påvirkning og cirkularitet via vores igangværende kampagne "Use Better, Use Longer, Use Again" for at forlænge produkternes levetid og genbrugelighed.

[Forklaring af Environmental Data >](#)

[Sådan vurderer vi produktets bæredygtighed >](#)

### Miljøaftryk

CO2-belastning (kg CO2 eq.)

1

Miljøoplysning

[Miljøprofil for produkt](#)

### Use Better

#### Materialer og emballage

Pakke med genbrugspap

Yes

Emballage uden plast

Yes

[EU RoHS-direktivet](#)

Proaktiv overensstemmelse (produkt ikke omfattet af EU RoHS)

Reach-forordning

[REACH-erklæring](#)

### Use Again

#### Ompakning og genfremstilling

Cirkularitetsprofil

[Oplysninger om udtjent udstyr](#)

Returnering

No

Dimensions Drawings

Dimensions

---

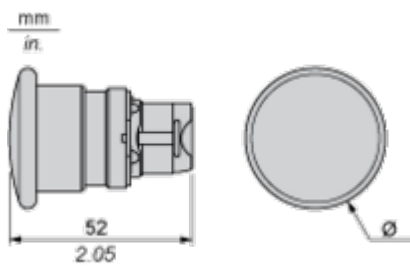

|        | Ø in mm | Ø in in. |
|--------|---------|----------|
| ZB5AC• | 40      | 1.57     |
| ZB5AR• | 60      | 2.36     |

Mounting and Clearance

**Panel Cut-out for Pushbuttons, Switches and Pilot Lights (Finished Holes, Ready for Installation)**

**Connection by Screw Clamp Terminals or Plug-in Connectors or on Printed Circuit Board**



- (1) Diameter on finished panel or support
- (2) For selector switches and Emergency stop buttons, use of an anti-rotation plate type ZB5AZ902 is recommended.
- (3) Ø22.5 mm recommended ( $\text{Ø}22.3_0^{+0.4}$ ) / Ø0.89 in. recommended ( $\text{Ø}0.88_0^{+0.016}$ )

| Connections                                   | a in mm | a in in. | b in mm | b in in. |
|---|---------|----------|---------|----------|
| By screw clamp terminals or plug-in connector | 40      | 1.57     | 30      | 1.18     |
| By Faston connectors                          | 45      | 1.77     | 32      | 1.26     |
| On printed circuit board                      | 30      | 1.18     | 30      | 1.18     |

**Detail of Lug Recess**



- (1) Diameter on finished panel or support
- (2) For selector switches and Emergency stop buttons, use of an anti-rotation plate type ZB5AZ902 is recommended.
- (3) Ø22.5 mm recommended ( $\text{Ø}22.3_0^{+0.4}$ ) / Ø0.89 in. recommended ( $\text{Ø}0.88_0^{+0.016}$ )





A: 1.18 in. min.  
 B: 1.57 in. min.

**General Tolerances of the Panel and Printed Circuit Board**

The cumulative tolerance must not exceed 0.3 mm / 0.012 in.: T1 + T2 = 0.3 mm max.

**Installation Precautions**

- Minimum thickness of circuit board: 1.6 mm / 0.06 in.
- Cut-out diameter: 22.4 mm ± 0.1 / 0.88 in. ± 0.004
- Orientation of body/fixing collar ZB5AZ009: ± 2° 30' (excluding cut-outs marked a and b).
- Tightening torque of screws ZBZ006: 0.6 N.m (5.3 lbf.in) max.
- Allow for one ZB5AZ079 fixing collar/pillar and its fixing screws:
  - every 90 mm / 3.54 in. horizontally (X), and 120 mm / 4.72 in. vertically (Y).
  - with each selector switch head (ZB5AD\*, ZB5AJ\*, ZB5AG\*).

The fixing centers marked a and b are diagonally opposed and must align with those marked 4 and 5.

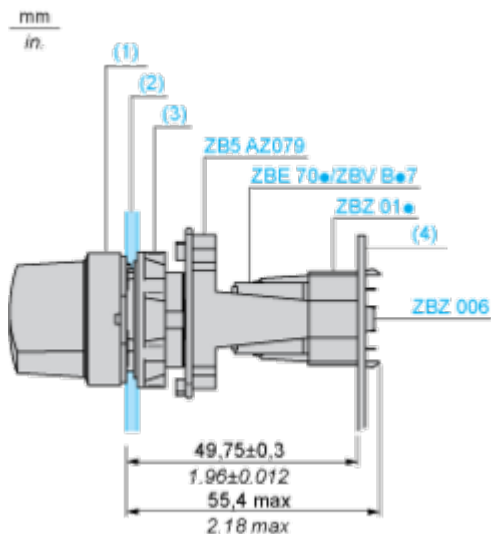

- (1) Head ZB5AD•
- (2) Panel
- (2) Nut
- (4) Printed circuit board

## Mounting of Adapter (Socket) ZBZ01•

- 1 2 elongated holes for ZBZ006 screw access
- 2 1 hole  $\varnothing$  2.4 mm  $\pm$  0.05 / 0.09 in.  $\pm$  0.002 for centring adapter ZBZ01•
- 3 8  $\times$   $\varnothing$  1.2 mm / 0.05 in. holes
- 4 1 hole  $\varnothing$  2.9 mm  $\pm$  0.05 / 0.11 in.  $\pm$  0.002, for aligning the printed circuit board (with cut-out marked **a**)
- 5 1 elongated hole for aligning the printed circuit board (with cut-out marked **b**)
- 6 4 holes  $\varnothing$  2.4 mm / 0.09 in. for clipping in adapter ZBZ01•

Dimensions An + 18.1 relate to the  $\varnothing$  2.4 mm  $\pm$  0.05 / 0.09 in.  $\pm$  0.002 holes for centring adapter ZBZ01•.

Technical Description

Electrical Composition Corresponding to Code C1

---



Electrical Composition Corresponding to Code C2

---



Electrical Composition Corresponding to Codes C9, C11, SF1 and SR1

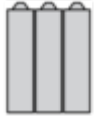

Electrical Composition Corresponding to Code C15

---

1 N/O



1 N/C



1 N/O + N/C or 1 N/O + N/O or 1 N/C + N/C



**Legend**

---

Single contact



Double contact



Light block



Possible location



Technical Illustration

Dimensions

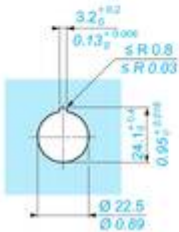
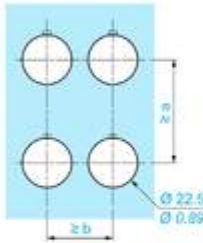
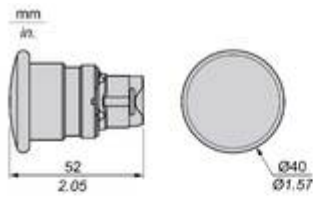

|  |                     | a (mm) | a (in.) | b (mm) | b (in.) |
|--|---------------------|--------|---------|--------|---------|
|  | ZBE..... ZBV.....   | 40     | 1.57    | 30     | 1.18    |
|  | ZBE.....3 ZBV.....3 | 45     | 1.77    | 32     | 1.26    |
|  | ZBE.....4 ZBV.....4 | 40     | 1.57    | 30     | 1.18    |
|  | ZBE.....5 ZBV.....5 | 50     | 1.97    | 30     | 1.18    |
|  | ZBE.....9 ZBV.....9 | 40     | 1.57    | 30     | 1.18    |
|  | ZBRT... ZBRV1       | 40     | 1.57    | 30     | 1.18    |

Offer Marketing Illustration

Product benefits / Features

---

## Technical Benefits

Harmony XB5



Offer Marketing Illustration

Product benefits / Features

---



The infographic features a central image of a Schneider XB5 terminal block with a grey cover. It is surrounded by five circular icons, each with a corresponding text description of a feature. The background is a solid green color.

### Features Harmony XB5

- Quick and easy assembly and disassembly** (Icon: crossed wrench and screwdriver)
- Excellent mechanical connection with operator head** (Icon: hand holding a terminal)
- Various types of connection: screw clamp, connector, Faston connector, spring terminal, or printed circuit board** (Icon: screwdriver)
- Large set of accessories to customize your panels** (Icon: gear with a pencil)
- Robustness to withstand harsh environments** (Icon: lightning bolt and rain cloud)

Image of product / Alternate images

Alternative

---



