

# Produktdatablad

Specifikationer



## Harmony trykknaphoved i plast med sort silikonehætte og fjederretur for brug med skilteholdere

El-nr.:  
7517907097

ZB5AP2S

EAN-nr: 3389110999372

### Egenskaber

|                                 |                          |
|---------------------------------|--------------------------|
| Produktserie                    | Harmony XB5              |
| Produkttype                     | Hoved til trykknop       |
| Enhedsforkortelse               | ZB5                      |
| Produktet passer med            | Skilteholder             |
| Materiale og farve på frontring | Mørkegrå plast           |
| Montagediameter                 | 22 mm                    |
| Hovedtype                       | Standard                 |
| Mindst mulige salgsantal        | 1                        |
| Form på hoved                   | Rundt                    |
| Betjeningsprofil                | fjeder-retur             |
| Betjeningsprofil                | Sort Plan, Uden mærkning |
| Yderligere egenskaber           | Farvet silikonehætte     |

### Produktinformationer

|                                  |   |
|----------------------------------|---|
| Bredde                           | 30 mm   |
| Højde                            | 30 mm   |
| Dybde                            | 33 mm   |
| Vægt                             | 0,021 kg  |
| Mekanisk holdbarhed              | 10000000 kredsløb   |
| Kanalnavn                        | XALD 1...5 montagehuller<br>XALK 2...5 montagehuller  |
| Kode for elektrisk sammensætning | C1 til <9 kontakter benytter enkelt blokke i Montering forfra<br>C2 til <9 kontakter benytter enkelt og dobbelt blokke i Montering forfra<br>C11 til <3 kontakter benytter enkelt blokke i Montering forfra<br>C15 til <1 kontakter benytter enkelt blokke i Montering forfra<br>SF1 til <3 kontakter benytter enkelt blokke i Montering forfra<br>SR1 til <3 kontakter benytter enkelt blokke i Montering bagfra |
| Konstruktion                     | Som løsdele   |

### Miljø

|                                     |                                   |
|-------------------------------------|-----------------------------------|
| Beskyttelsesbehandling              | TH                                |
| Omgivelsestemperatur ved opbevaring | -40...70 °C                       |
| Omgivelsestemperatur under drift    | -40...70 °C                       |
| Overspændingskategori               | Klasse II conforming to IEC 60536 |

|  |  |
|--|--|
| <b>IP kapslingsklasse</b>                          | IP66 i henhold til IEC 60529<br>IP67 i henhold til IEC 60529<br>IP69 i henhold til IEC 60529<br>IP69K i henhold til ISO 20653  |
| <b>NEMA kapslingsklasse</b>                        | NEMA 13<br>NEMA 4X   |
| <b>Modstandsdygtighed overfor højtryksrensning</b> | 7000000 Pa ved 55 °C, distance : 0.1 m   |
| <b>IP kapslingsklasse</b>                          | IK03 conforming to IEC 50102   |
| <b>Standarder</b>                                  | IEC 60947-5-1<br>CSA C22.2 No 14<br>UL 508<br>IEC 60947-5-4<br>JIS C8201-5-1<br>IEC 60947-1<br>JIS C8201-1   |
| <b>Produktcertificeringer</b>                      | CSA<br>DNV<br>BV<br>LROS (Lloyds register of shipping)<br>UL listet  |
| <b>Modstandsdygtighed overfor stød</b>             | 30 gn (varighed = 18 milisekund) til Halv sinusbølge acceleration i henhold til IEC 60068-2-27<br>50 gn (varighed = 11 milisekund) til Halv sinusbølge acceleration i henhold til IEC 60068-2-27 |
| <b>Vibrationsmodstand</b>                          | 5 gn (f= 2...500 Hz) conforming to IEC 60068-2-6   |

## Forpakkingsinformation

|                                |          |
|--------------------------------|----------|
| <b>Enhedstype af pakke 1</b>   | PCE      |
| <b>Antal enheder i pakke 1</b> | 1        |
| <b>Pakke 1 Højde</b>           | 4,7 cm   |
| <b>Pakke 1 Længde</b>          | 3,6 cm   |
| <b>Package 1 Length</b>        | 5,7 cm   |
| <b>Pakke 1 Vægt</b>            | 18 g     |
| <b>Enhedstype af pakke 2</b>   | BB1      |
| <b>Antal enheder i pakke 2</b> | 5        |
| <b>Pakke 2 Højde</b>           | 4,5 cm   |
| <b>Pakke 2 Bredde</b>          | 26,5 cm  |
| <b>Pakke 2 Længde</b>          | 3,4 cm   |
| <b>Pakke 2 Vægt</b>            | 94 g     |
| <b>Enhedstype af pakke 3</b>   | S03      |
| <b>Antal enheder i pakke 3</b> | 200      |
| <b>Pakke 3 Højde</b>           | 30 cm    |
| <b>Pakke 3 Bredde</b>          | 30 cm    |
| <b>Pakke 3 Længde</b>          | 40 cm    |
| <b>Pakke 3 Vægt</b>            | 4,286 kg |

## Logistik informationer

|                        |    |
|------------------------|----|
| <b>Oprindelsesland</b> | FR |
|------------------------|----|

## Garanti

---

Garanti

18 months

## Environmental Data

Schneider Electric's mål er at opnå Net Zero-status i 2050 gennem partnerskaber med forsyningskæden, materialer med lavere påvirkning og cirkularitet via vores igangværende kampagne "Use Better, Use Longer, Use Again" for at forlænge produkternes levetid og genbrugelighed.

[Forklaring af Environmental Data >](#)

[Sådan vurderer vi produktets bæredygtighed >](#)

### Miljøaftryk

CO2-belastning (kg CO2 eq.) 1

Miljøoplysning [Miljøprofil for produkt](#)

### Use Better

#### Materialer og emballage

Pakke med genbrugspap Yes

Emballage uden plast Yes

[EU RoHS-direktivet](#)

Proaktiv overensstemmelse (produkt ikke omfattet af EU RoHS)

Reach-forordning

[REACH-erklæring](#)

### Use Again

#### Ompakning og genfremstilling

Cirkularitetsprofil [Oplysninger om udtjent udstyr](#)

Returnering No

Dimensions Drawings

Dimensions

---

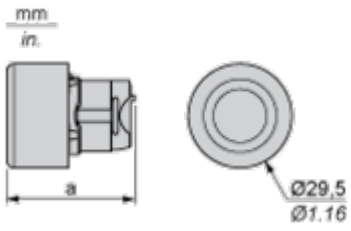

|          | a in mm | a in in. |
|----------|---------|----------|
| ZB5AP••  | 36.5    | 1.44     |
| ZB5AP•S  | 33      | 1.30     |
| ZB5AP•83 | 32      | 1.26     |
| ZB5AP•   | 35      | 1.38     |

Mounting and Clearance

Panel Cut-out for Pushbuttons, Switches and Pilot Lights (Finished Holes, Ready for Installation)

Connection by Screw Clamp Terminals or Plug-in Connectors or on Printed Circuit Board



- (1) Diameter on finished panel or support
- (2) For selector switches and Emergency stop buttons, use of an anti-rotation plate type ZB5AZ902 is recommended.
- (3)  $\varnothing 22.5$  mm recommended ( $\varnothing 22.3_0^{+0.4}$ ) /  $\varnothing 0.89$  in. recommended ( $\varnothing 0.88$  in.  $_0^{+0.016}$ )

| Connections                                   | a in mm | a in in. | b in mm | b in in. |
|---|---------|----------|---------|----------|
| By screw clamp terminals or plug-in connector | 40      | 1.57     | 30      | 1.18     |
| By Faston connectors                          | 45      | 1.77     | 32      | 1.26     |
| On printed circuit board                      | 30      | 1.18     | 30      | 1.18     |

Detail of Lug Recess



- (1) Diameter on finished panel or support
- (2) For selector switches and Emergency stop buttons, use of an anti-rotation plate type ZB5AZ902 is recommended.
- (3)  $\varnothing 22.5$  mm recommended ( $\varnothing 22.3_0^{+0.4}$ ) /  $\varnothing 0.89$  in. recommended ( $\varnothing 0.88$  in.  $_0^{+0.016}$ )

Pushbuttons, Switches and Pilot Lights for Printed Circuit Board Connection

Panel Cut-outs (Viewed from Installer's Side)

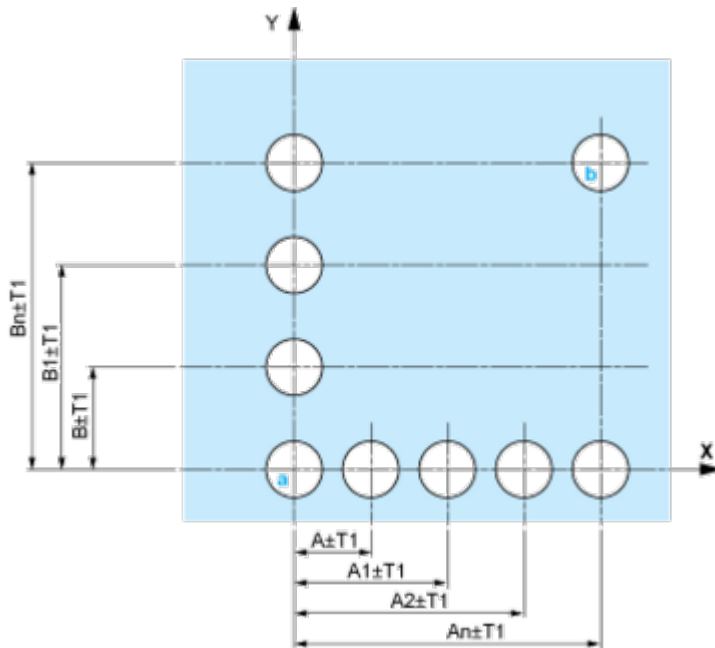

A: 30 mm min. / 1.18 in. min.

B: 40 mm min. / 1.57 in. min.

Printed Circuit Board Cut-outs (Viewed from Electrical Block Side)

Dimensions in mm

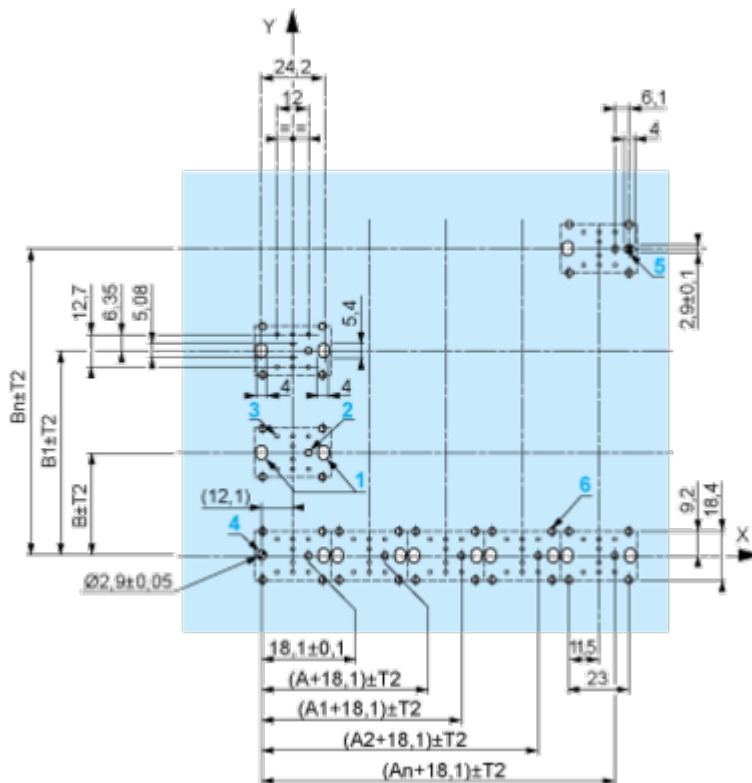

A: 30 mm min.

B: 40 mm min.

Dimensions in in.



A: 1.18 in. min.  
 B: 1.57 in. min.

**General Tolerances of the Panel and Printed Circuit Board**

The cumulative tolerance must not exceed 0.3 mm / 0.012 in.: T1 + T2 = 0.3 mm max.

**Installation Precautions**

- Minimum thickness of circuit board: 1.6 mm / 0.06 in.
- Cut-out diameter: 22.4 mm ± 0.1 / 0.88 in. ± 0.004
- Orientation of body/fixing collar ZB5AZ009: ± 2° 30' (excluding cut-outs marked a and b).
- Tightening torque of screws ZBZ006: 0.6 N.m (5.3 lbf.in) max.
- Allow for one ZB5AZ079 fixing collar/pillar and its fixing screws:
  - every 90 mm / 3.54 in. horizontally (X), and 120 mm / 4.72 in. vertically (Y).
  - with each selector switch head (ZB5AD\*, ZB5AJ\*, ZB5AG\*).

The fixing centers marked a and b are diagonally opposed and must align with those marked 4 and 5.

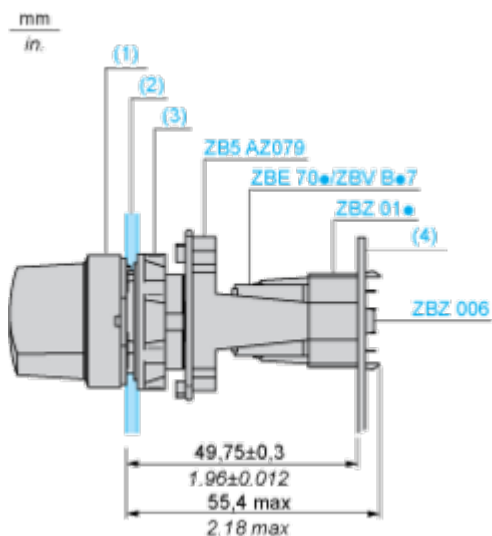

- (1) Head ZB5AD•
- (2) Panel
- (2) Nut
- (4) Printed circuit board

## Mounting of Adapter (Socket) ZBZ01•

- 1 2 elongated holes for ZBZ006 screw access
- 2 1 hole  $\varnothing$  2.4 mm  $\pm$  0.05 / 0.09 in.  $\pm$  0.002 for centring adapter ZBZ01•
- 3 8  $\times$   $\varnothing$  1.2 mm / 0.05 in. holes
- 4 1 hole  $\varnothing$  2.9 mm  $\pm$  0.05 / 0.11 in.  $\pm$  0.002, for aligning the printed circuit board (with cut-out marked **a**)
- 5 1 elongated hole for aligning the printed circuit board (with cut-out marked **b**)
- 6 4 holes  $\varnothing$  2.4 mm / 0.09 in. for clipping in adapter ZBZ01•

Dimensions An + 18.1 relate to the  $\varnothing$  2.4 mm  $\pm$  0.05 / 0.09 in.  $\pm$  0.002 holes for centring adapter ZBZ01•.

Technical Description

Electrical Composition Corresponding to Code C1

---



Electrical Composition Corresponding to Code C2

---



Electrical Composition Corresponding to Codes C9, C11, SF1 and SR1

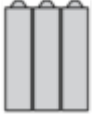

Electrical Composition Corresponding to Code C15

---

1 N/O

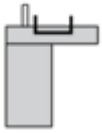

1 N/C



1 N/O + N/C or 1 N/O + N/O or 1 N/C + N/C

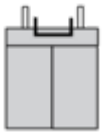

**Legend**

---

Single contact



Double contact



Light block



Possible location



Technical Illustration

Dimensions

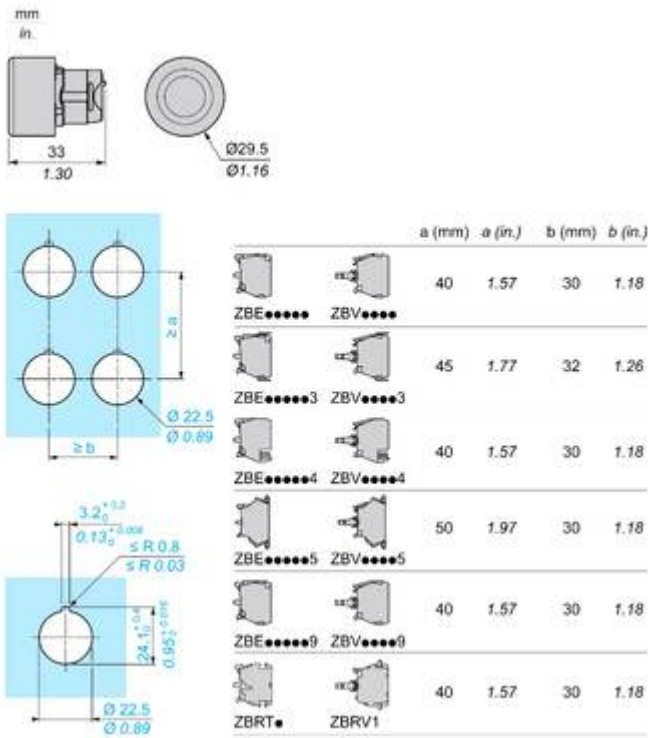

Offer Marketing Illustration

Product benefits / Features

---

## Technical Benefits

Harmony XB5



Offer Marketing Illustration

Product benefits / Features

---



The infographic features a central image of a Schneider XB5 terminal block with a grey cover. It is surrounded by five circular icons, each with a corresponding text description of a feature. The background is a solid green color.

### Features Harmony XB5

- Quick and easy assembly and disassembly** (Icon: crossed wrench and screwdriver)
- Excellent mechanical connection with operator head** (Icon: hand holding a terminal)
- Various types of connection: screw clamp, connector, Faston connector, spring terminal, or printed circuit board** (Icon: screwdriver)
- Large set of accessories to customize your panels** (Icon: gear with a pencil)
- Robustness to withstand harsh environments** (Icon: lightning bolt and rain cloud)

Image of product / Alternate images

Alternative

---





