



# VIKING

## Safety cutter

Ø 30 – 400 mm

Art.no. 79 100 30400



## Capacity

- This tool is capable of cutting round holes of diameter Ø 40 – 300mm.
- Max. cutting depth 30 mm (however max. 1 mm in metal).
- The TCT cutter used for the cutting of aluminium, sheet iron plate, plastic, wood.
- The HSS cutter used for the cutting of woodworker, plastic.

## Caution!

- When cutting into walls, floors or ceilings ALWAYS check to ensure that no electric cables or water pipes etc. are in the vicinity of the proposed cut.
- ALWAYS keep the cutting blades sharp.
- DO NOT use undue force, or too great a drill speed (see chart on next page).
- Ensure the cutting blade holders are tight before use.
- Ensure the cutting blades are the correct way round (see illustration on next page)

## Setup

Using the Hex wrench supplied, adjust the cutting blade holders so that the cutting blades are at the desired diameter. The inner edge of the holders should line up with the appropriate graduation on the arm. It is important to note the orientation of the cutting blades, refer to 'A' on illustration below to ensure they are correct. Cutting blades should turn same way.

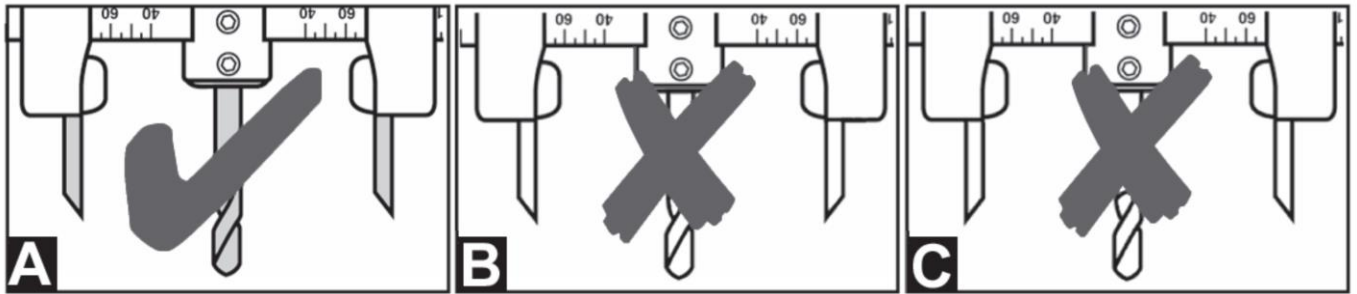

Correct

Incorrect

Incorrect

### Cutting guidance – see illustration on the right

**STEP 1.** With the cutter blades correctly adjusted and holders perfectly secure, slide the spindle through the hole in the protection cowl.

**STEP 2.** Slide the compression spring on to the protruding spindle.

**STEP 3.** Screw the wing nut on to the threaded end of the spindle in the manner shown so that the assembly is secure. Attach the assembly to a suitable variable speed hand drill ensuring the spindle is perfectly secure. Select a speed in accordance with the chart below. Very carefully offer the complete assembly up to the workpiece switch ON and allow the pilot drill to begin its work. The protection cowl will quickly come into contact with the workpiece....ensure it is SQUARE. Continue to push the spindle inwards, but DO NOT force it, allow the cutters to come into contact with the work very gently. If the cutters grab, the tool could be wrenched from your grasp. Take care at this point.

**NOTE:** Depth of cut may be set by adjusting the compression spring wing nut, noting that it has a left hand thread. If it is possible to cut from both sides of the workpiece, then the maximum thickness that may be cut is 60mm. In order to do this, first proceed to cut from one side as described, then using an 8mm drill bit, drill the pilot hole through the remaining thickness. Finally, very carefully cut from the reverse side of the workpiece ensuring the pilot drill of the cutter, neatly enters the pilot hole previously drilled.

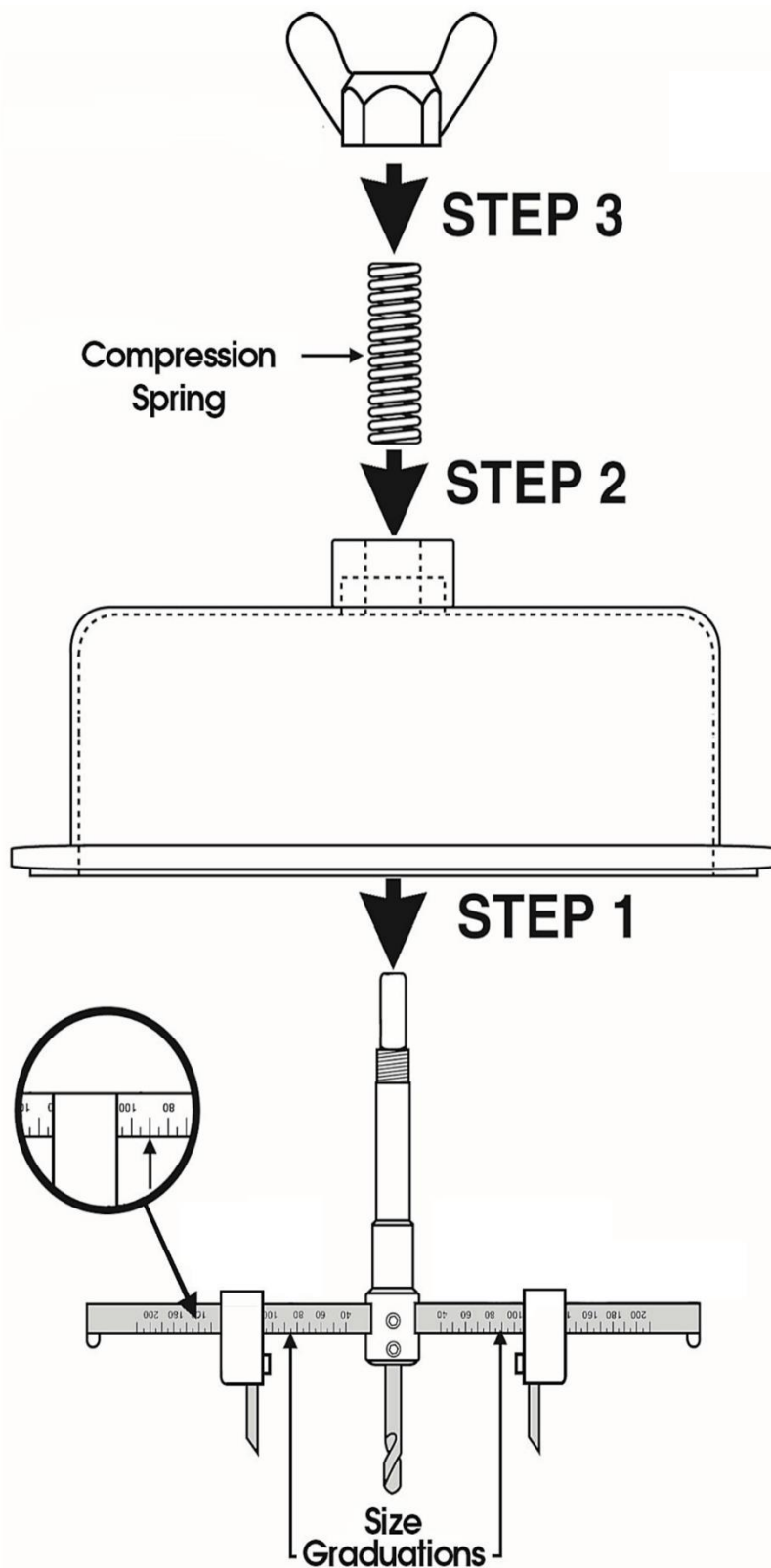

## CUTTING SPEEDS

Hole Dia (mm)	Drill Speed (RPM)
40 - 49 mm .....	800 RPM
50 - 69 mm .....	600 RPM
70 - 89 mm .....	400 RPM
90 - 119 mm .....	200 RPM
120 - 199 mm .....	100 RPM
200 - 300 mm .....	50 RPM

## Spare parts

Cutter Diameter	Cutter Art. no.	Cutter blade Spare part no.	Drill Spare part no.
<p>Ø 40 – 300 mm</p> 	<p>79 100 40300</p> 	<p>79 100 40310 HSS For wood (2 pcs.)</p>  <p>79 100 40320 TCT For wood/metal (2 pcs.)</p> 	<p>79 100 40315 HSS</p>  <p>79 100 40325 TCT</p> 
<p>Ø 30 – 163 mm</p> 	<p>79 100 51</p> 	<p>79 100 53 (wood)</p>  <p>79 100 54 (metal)</p> 	<p>79 100 56</p> 
<p>Ø 55 – 255 mm</p> 	<p>79 100 70</p> 	<p>79 100 71 (wood 2 pcs)</p> 	

# VIKING