



ENGLISH

Outdoor PTZ Rotating 4G Camera



* Solar panel included
for endless power.

* Actual solar panel **bracket** may
be different. Please refer to the
physical product.



Rechargeable
Battery Inside

User Manual

ZMG120

Thank you for purchasing our ZmartGear Outdoor PTZ Rotating 4G Camera. Before using your new camera, please read this manual carefully. Please fully charge your camera before the initial use.

Product Layout

- | | | |
|--|-------------------------|-----------------|
| ① Indicator Light | ⑥ PIR Sensor | ⑩ On-Off Button |
| ② Lens | ⑦ Speaker | ⑪ Solar Panel |
| ③ MIC | ⑧ Mounting bracket base | |
| ④ IR & Spot Light | ⑨ Antenna | |
| ⑤ *Reset / MicroSD Card Slot / 4G Sim card Slot) | | |

*Note: The reset button/4G SIM card slot / microSD card slot are located in a sealed compartment. This compartment may be hidden under a protective cover and may require you to manually adjust the camera to locate and open it.

The package includes:

- 4G PTZ Camera x1
- Solar Panel x 1
- Solar Panel Mount bracket x 1
- * Camera Mounting plate x 1
- * Metal Band x 2
- Screw package x 2
- User Manual x 1
- Hole marking sticker x 1

* **Camera Mounting plate and Metal Bands** are used for "Pole Mounting". They secure the camera to a cylindrical pole, such as a utility pole, and tighten the solar panel.

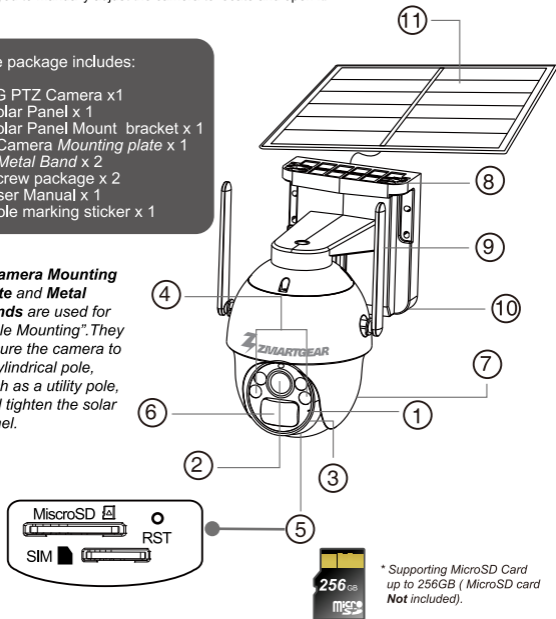

* Supporting MicroSD Card up to 256GB (MicroSD card **Not** included).

Connecting/Add the camera

The ZMG120 outdoor PTZ Rotating 4G camera is designed to function solely on a 4G network. Before using the camera, please verify that the inserted 4G SIM card has been activated and that your mobile device is connected to a stable internet network.

Open the **Smart Life** app and look for the blue "+" icon in the top-right corner of the screen and tap it to begin adding a new device.



Smart Life App

Get the **Smart Life** app on the Apple Store or Google Play Store

If you're using the Smart Life app for the first time and haven't added any devices yet, you'll see a large "Add Device" button in the center of the screen. Simply tap this button to begin adding a new device.

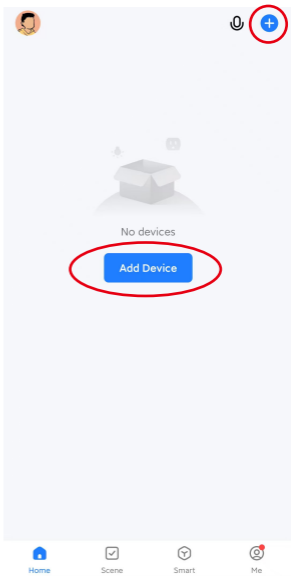

* NOTE

When using Smart Life for the first time, please follow the on-screen instructions to sign up for a new account. Make sure to remember the email address you use, as it will be essential for tasks like password recovery.

Connecting/Add the camera

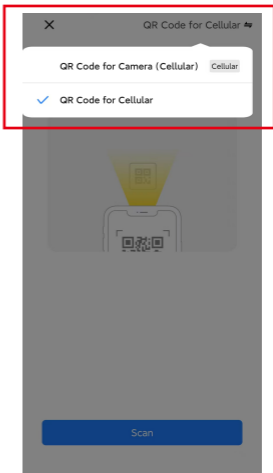
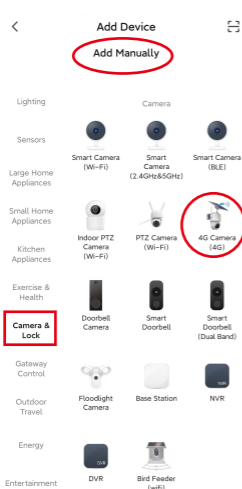

Choose to **"Add Manually"** to manually add the camera. Scroll down and select **"Add Manually"**, then choose **"Camera & Lock"** followed by **"4G Camera(4G)"**. Make sure that you see **"QR code for Cellular"** in the upper right corner of the screen. If Not, tap on the text next to the  icon to enter the options and select **"QR Code for Cellular"**.

Follow the on-screen instructions to scan the **QR code on the camera body** using your mobile device to add the ZMG120 camera. Once the addition is successful, the camera will emit a confirmation sound.

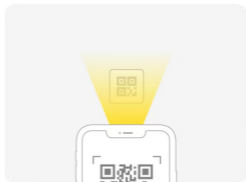

Connecting/Add the camera

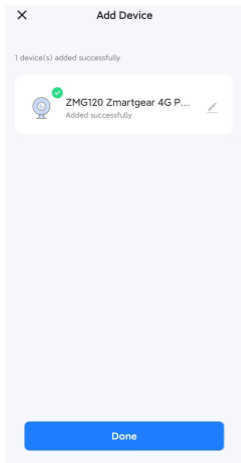

The app will guide you through the 4G connection and adding the camera to your Smart Life App account. Once it is successful, the camera will be added to your Smart Life app account, allowing you to control and monitor it remotely.

* NOTE

- Make sure that the inserted 4G SIM card has been activated and that your mobile device is connected to a stable internet network.
- Each device can only be paired with one app account at a time. If the device is already linked to an account, it cannot be paired with another.

To remove the device from an account, simply delete it from the app. And before pairing the camera with a new Smart Life App account, please reset the camera.

How to reset the camera

Use a pin to press and hold the reset button for about 3 seconds. You will hear a confirmation tone indicating that the reset is complete.

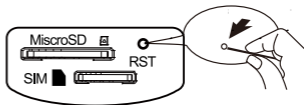

Main features of the camera

Night Mode:

Night Mode offers 3 options: **Smart Mode/ Infrared Mode/Color Light Mode**. Infrared Mode provides black-and-white images with low power consumption. Color Light Mode offers color images but requires LED fill light, resulting in higher power consumption. Smart Mode intelligently switches from black-and-white to color images when motion of human body is detected.

PIR Sensitivity:

The PIR offers three sensitivity levels: low, medium, and high.

Motion Detection:

Enable motion detection to detect human movement and send notifications.

Motion Tracking:

Enable motion tracking. The camera will automatically pan and tilt to follow detected human movement when motion detection is also activated.

Siren:

The siren can be manually activated to produce an alarm sound and deter intruders.



Direction:

Tap on this icon and manually pan and tilt the camera to obtain a comprehensive view.

Call:

The Call function enables real-time communication, allowing you to verbally deter intruders or engage in real-time voice conversations with visitors.

Selecting "one-way" communication in the settings will result in the microphone  icon being displayed.

 **One-way Call** Verbally deter intruders with a simple tap and hold of the  icon, or engage in real-time voice conversations with visitors.

* Recording:

This recording function lets you record videos in real-time and save them directly to your phone or mobile device.

* NOTE

This recording function allows you to record videos in real-time and save them directly to your phone or mobile device. Unlike camera local storage, which requires a TF card, or cloud storage, which needs a subscription, both can only be accessed via the **Playback** feature.

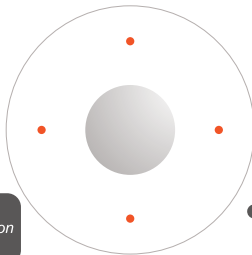

← ZMG120 Zmartgear 4G PT... 

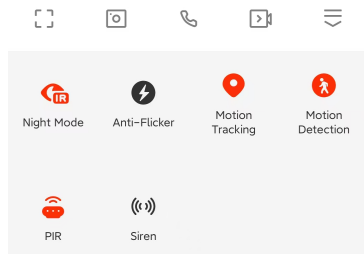
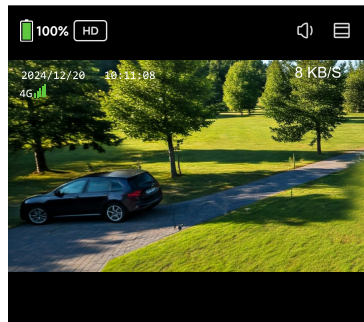

Slide the bar at the bottom of the screen to the left/right to view additional icons for various functions



More settings . . .

Tap the . . . icon in the upper right corner to access additional settings and services.

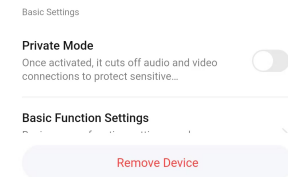
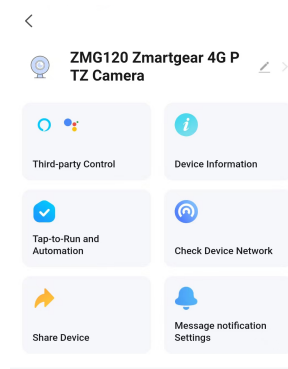

Smart Life App

Get the **Smart Life** app on the Apple Store or Google Play Store

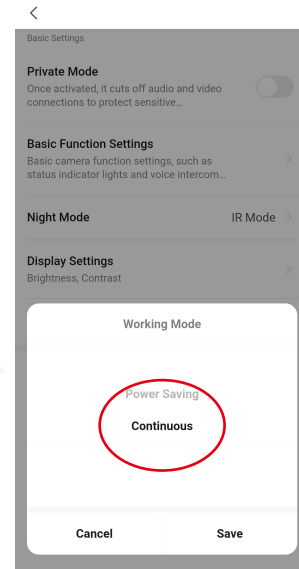

Powered by an **18,000mAh battery** and **7W solar panel**, The ZMG120 4G PTZ Camera provides **24/7 recording** in "Continuous" mode and event-based recording in "Power Saving" mode.

* NOTE

- The **Smart Life app** is a third-party application, and some services, such as Cloud Storage, are paid features that require payment to Smart Life for access.
- Please keep your app updated to the latest version as the interface and available features may change with each update.

Installation

ZMG120 4G PTZ camera offers three mounting options: **Ceiling mount**, **Wall mount**, and **Pole mount**.

Ceiling Mount :

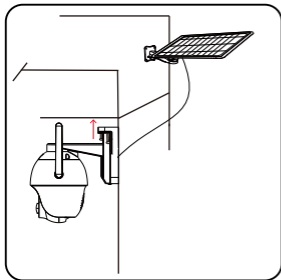

Wall Mount :

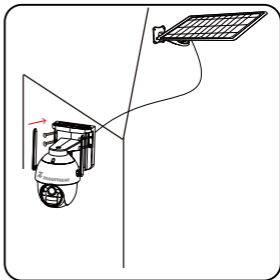

Pole Mount :

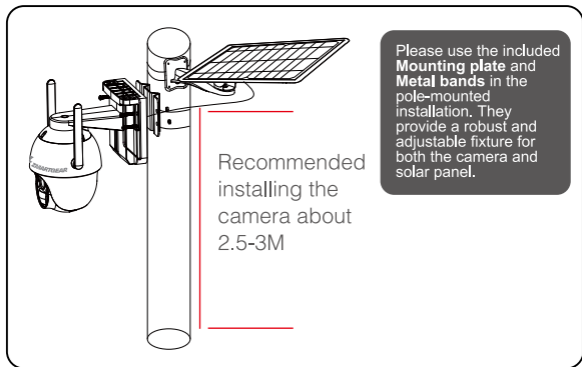

Warning

Warnings and Safety Instructions for PTZ 4G Outdoor Surveillance Camera

- **Power Supply:** Ensure the power supply voltage matches the camera's specifications.
- **Installation Location:** Avoid installing the camera near strong magnetic fields or electrical interference.
- **Avoid installing the camera in areas with disturbed airflow**, such as near air conditioner vents, heat exhausts, fan sides, or close to curtains.
- **Maintenance:**
 - /Clean the camera lens regularly with a soft, dry cloth.
 - /Avoid using abrasive or chemical cleaners that could damage the camera.
- **Handling and Storage:**
 - /Do **Not** attempt to disassemble the camera, as this could void the warranty.
 - /Store the camera in a cool, dry place when not in use.

* NOTE

- *Follow local laws and regulations regarding surveillance and privacy.*
- *Notify individuals in the monitored area if required by law.*

Disposal of electronic waste

Electrical and electronic equipment (EEE) contains materials, components and substances that can be hazardous and harmful to human health and the environment when electrical waste and electronic equipment (WEEE) is not disposed of properly. Products marked with the crossed-out bin below are electrical and electronic equipment. The crossed bin symbolizes that waste is electrical and electronic equipment must not be disposed of with unsorted household waste, but must be collected separately.

All municipalities have set up collection schemes where waste electrical and electronic equipment can be delivered free of charge by citizens to recycling stations or other collection points or collected directly from households. Further information must be obtained from the municipality's technical administration.

Users of electrical and electronic equipment shall not dispose of waste electrical and electronic equipment with household waste. Users shall use municipal collection schemes to reduce the environmental impact of the disposal of waste electrical and electronic equipment and to increase the possibilities for reuse, recycling and recovery of waste electrical and electronic equipment.



Frequently Asked Questions (FAQ)

Q1: Camera Not Connecting to 4G

A: Ensure the SIM card is correctly inserted and supports 4G. Check that the SIM card has an active data plan. Confirm the camera's signal strength is sufficient. Restart the camera after inserting the SIM card. Verify the APN settings in the app match your carrier's requirements, as it is case-sensitive.

Q2: Why is the camera offline?

A: Check if the SIM card has sufficient data and is inserted correctly. Ensure the camera is in an area with strong 4G signal coverage. Restart the camera and confirm it is powered on. Verify the APN settings in the app are configured for your carrier. Check for any account or service restrictions with your mobile provider.

Q3: What happens when the SD card is full?

A: New recordings will overwrite the oldest videos.

Q4: Why can't a shared account operate the camera?

A: Shared accounts have limited permissions. To operate the camera, log in with the main account.

Specifications

Camera

- . Sensor : 1/2.8" CMOS, 100°
- . Resolution: 4MP (2560x1440)
- . Lens: 4 mm
- . Frame Rate: 15 FPS
- . Video Compression: H.265
- . Infrared Night Vision: 4 IR LEDs
- . Infrared Distance: 20 Meter
- . White Light: 4 LEDs
- . PIR Motion Detection distance: 10 Meter
- . PIR Detection Angle: 120-degree
- . Horizontal rotation angle: 0 ~ 350 degrees
- . Vertical rotation: 0 ~ 90 degrees

- . Working Temperature: -20°C to 55°C
- . Working Humidity: 10% to 95% RH
- . Waterproof: IP65
- . Supporting Micro SD card: 256GB Max.
- . 4G Standard : 4G LTE
- . 4G Frequency Bands:
FDD-LTE: B1/B3/B5/B7/B8/B20/B28
TDD-LTE: B38/B40/B41

- . Input: DC5V/1A
- . Battery Capacity: 18,000mAh
- . Output: DC 5V/1A (5W max.)
- . Dimension: 130*186 * 175mm
- . Weight: 833 g

Solar Panel

- . Output (USB Type C): 7W
- . Output Cable Length: 3 M
- . Waterproof: IP65
- . Dimension: 265*175 * 20mm
- . Weight: 475 g



*CEPELO A/S
Nibevej 54
9200 Aalborg SV
Denmark
+4598180900
info@cepelo.dk
www.cepelo.dk*

RoHS CE