

MODULAR JACK KAT6/ KAT6A UTP RJ45

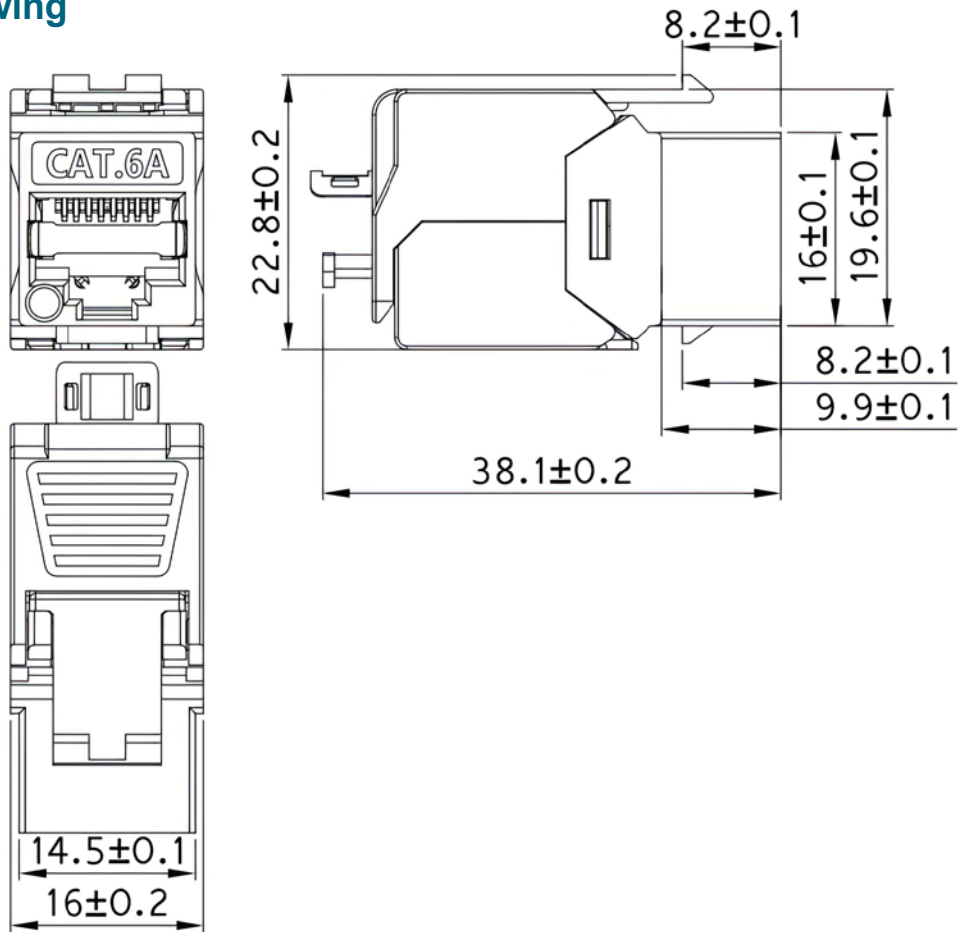

STATIONSALLEEN 40 • DK-2730 HERLEV

Technical Drawing



Installation Method

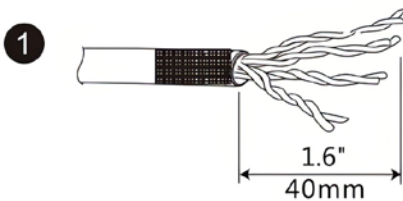

Remove 40mm (1.6") of cable outer jacket
Fold back the foil / braid and the drain wire

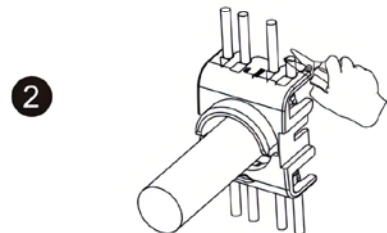

Insert the cable through the termination cap, untwist the four pairs and fan out. Following the colour code on the cap, insert the wires into their designated slots. Double check the wires are in the correct positions and then trim off the excess.

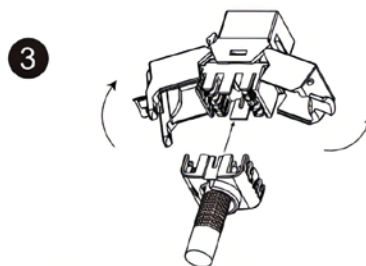

Position the termination cap on the keystone IDCs, in the correct orientation.

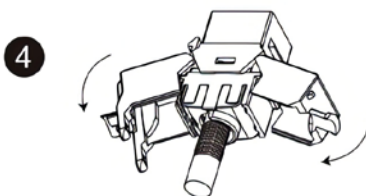

Push the termination cap down and then close the wings.

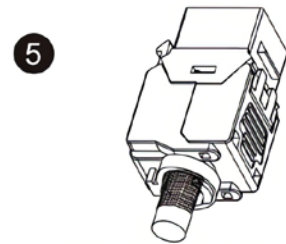

Assemble the keystone jack on face plate or patch panel

JACK PIN DESIGNATIONS	TIA / EIA T568A	TIA / EIA T568B
	1	White/Green
2	Green	Orange
3	White/Orange	White/Green
4	Orange	Green
5	Blue	Blue
6	White/Blue	White/Blue
7	White/Brown	White/Brown
8	Brown	Brown